

IP67 COB 桑拿灯带

- 1- 采用COB灯珠，无光斑，IP67
- 2- 100Lm/W超高光效，节能省电
- 3- 耐高温耐湿，可用于桑拿房



产品参数

| 型号 | 电压 | 色温/K | 功率/米 | 显指 | 流明/米 | 流明/英尺 | 流明/瓦 | 裁剪位 | 最长连接长度 |
|----------------------------|-----|-------|------|-----|------|-------|------|------|--------|
| MF309V480Q90-D027A3A10308N | 24V | 2700k | 10 | >90 | 950 | 290 | 95 | 50mm | 5米 |
| MF309V480Q90-D030A3A10308N | 24V | 3000k | 10 | >90 | 950 | 290 | 95 | 50mm | 5米 |
| MF309V480Q90-D040A3A10308N | 24V | 4000k | 10 | >90 | 1000 | 305 | 100 | 50mm | 5米 |
| MF309V480Q90-D050A3A10308N | 24V | 5000k | 10 | >90 | 1000 | 305 | 100 | 50mm | 5米 |
| MF309V480Q90-D065A3A10308N | 24V | 6500k | 10 | >90 | 1000 | 305 | 100 | 50mm | 5米 |

光学参数

| | |
|-------|------------------------------------|
| 灯珠类型: | COB |
| 显指: | Ra>90 |
| 色温: | 2700K, 3000K, 4000K, 5000K, 6500K. |
| 发光角度: | 140° |
| 光效: | 95-100Lm/w |
| 流明/米: | 950-1000Lm/米 |
| 质保: | 3年 |

电性参数 (24V)

| | |
|---------|------------|
| 输入电流/米: | 0.42A/米 |
| 输入电压: | DC24V |
| 功率/米: | 10W/米 |
| 抗静电: | 2000V(ESD) |
| 灯珠数/米: | 480LEDs/m |
| 裁剪长度: | 50mm |
| 灯珠/组: | 24LEDs |

尺寸图

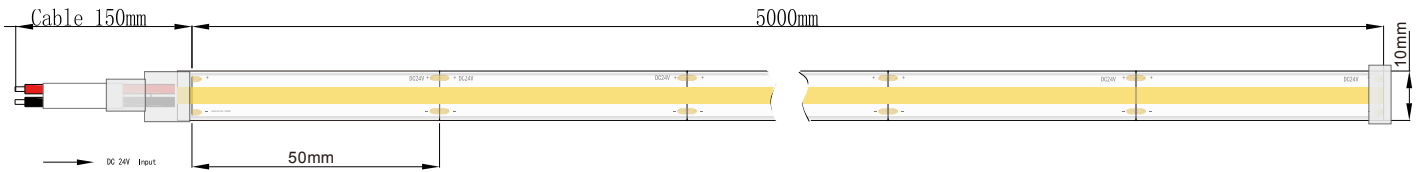

防水等级

防水等级细则

IP20: 防护12.5mm直径和更大的固体外来体

IP54 纳米涂层: 防护灰尘, 防护淋水

IP65 表滴硅胶/PU胶: 灰尘封闭, 防护喷水

IP65 硅胶空心挤出: 灰尘封闭, 防护喷水

IP67 PU半套管滴PU胶: 灰尘封闭, 防护短时浸水

IP67 硅胶空心挤出: 灰尘封闭, 防护短时浸水

IP68 硅胶套管抽硅胶: 灰尘封闭, 防护长期浸水

IP68 硅胶实心挤出: 灰尘封闭, 防护长期浸水

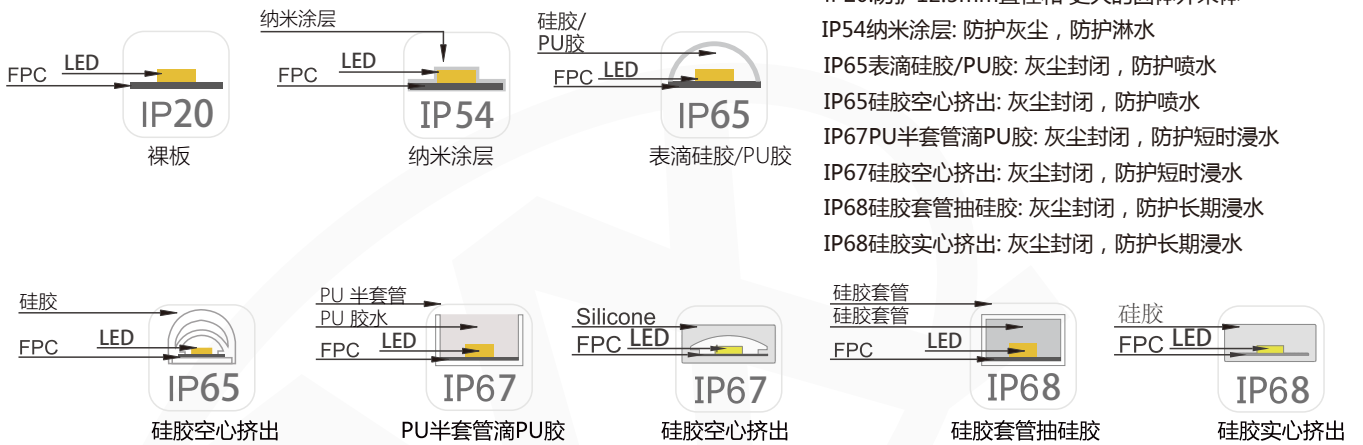

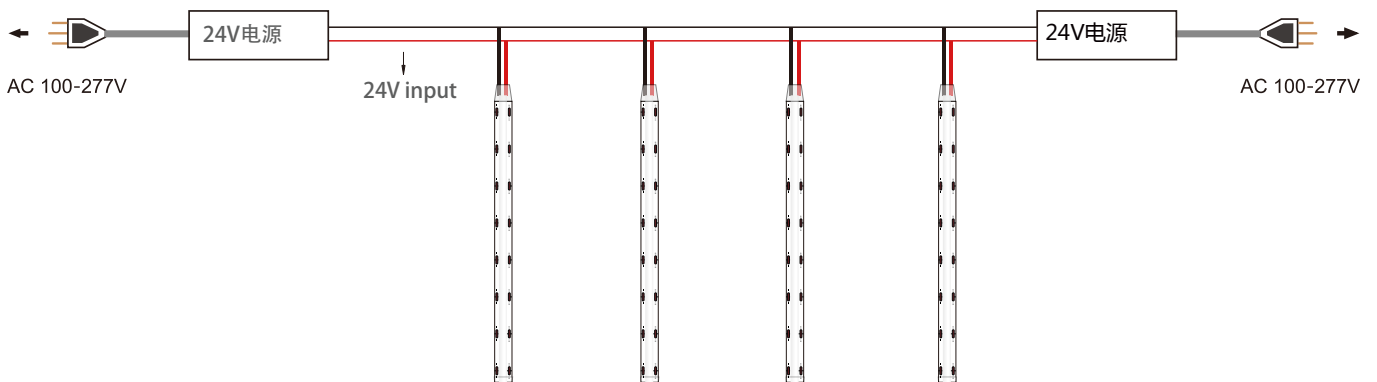

接线图应用图

◆ 5米单端供电



|| 控制器

| 图片 | 款式 | 型号 | 规格 | 匹配 |
|-----------------------------------------------------------------------------------|-------|--------------|-------------------------------------------------------------------------------------------------------------------------------------------------------------|--------|
|  | 单色遥控器 | MX-03-030472 | Output signal:RF(2.4GHz) Working voltage:3VDC(CR2032) Remote control distance:30m Working temperature:Ta:-30°C~+55°C | 匹配单色灯带 |
|  | 单色控制器 | MX-03-030322 | Input voltage:12-48VDC Output current:15A@12/24V-10A@36/48V Output Power:180W@12V-360W@24V 360W@36V-480W@48V Working temperature:Ta:-30°C~+55°C | 匹配单色灯带 |

标准线标 (具体请看实际产品线标)

○ 单色

Red: V+
Black: GND



可靠性测试

| 测试类型 | 测试项目 | 测试标准 | |
|-----------------------------------------------------------------------------------------------------------------------------------------------------------------------------------------------------------|--------------------------------------|-------------------------------------------------------------------------------------------------------------------------------------------------------------------------------------------------------------|-------------------------------------|
| 1-FIND REPEATED TEST 2-RE ARRAGE ORDER 3-CONFIRM STANDARD * 4-REQUIRED EQUIPMENT FOR TEST ** 5-CONFIRM ALREADY AVAILABLE EQUIPMENT WITH LIAO *** 6-CONFIRM ETA FOR MISSING EQUIPMENTS **** | ITEM | DESCRIPTION | REQUIRED EQUIPMENT FOR TEST ** |
| PHOTOMETRIC TEST | Spectrum Analysis | LM 79(lumen,CCT,CRI,XY,SDCM,wave length) | <input checked="" type="checkbox"/> |
| | Photometric Distribution | LM 79(lumen intensity distribution&Lux diagram) | <input checked="" type="checkbox"/> |
| ELECTRICAL TEST | ESD test | IEC61000-4-2/ANSI-ESDSTM5.1.2 | |
| | EMC Test | IEC 61547/GBT 18595 IEC 61000-3-2/GB 17625.1 | <input checked="" type="checkbox"/> |
| MECHANICS & PHYSICE TESTING | Bending Test Vertical | Manufacturer-defined,500 cycles 3 times bending with 0.5m/s pulling speed | |
| | Bending Test Horizontal | Manufacturer-defined,500 cycles 3 times bending with 0.5m/s pulling speed | |
| | Swing Tes | UL2388,>750 cycles | |
| | Tensile Test | Manufacture-defined,>the weight of light in maximum connection length wiht both ends feed With 30Nm if total cross section <0,75 or 60Nm force, pull wire 25 timesduring 1 sec. Mark displacement ≤ 2mm. | <input checked="" type="checkbox"/> |
| | Twist Test | Manufacturer-defined,>200 cycles in 720° | <input checked="" type="checkbox"/> |
| | Adhesion test | 3M 4229P hung on 2kg loads >7 hrs | <input checked="" type="checkbox"/> |
| | drop test | IEC68-2-6,GB/T2423/10/95 | <input checked="" type="checkbox"/> |
| | Vibration tes | I bear up to 25,4mm amplitude in 14200 cycles | |
| | Insulation Resistanc | ≅ 2MΩ | <input checked="" type="checkbox"/> |
| | Electrical strength | 500V | <input checked="" type="checkbox"/> |
| ENVIRONMENT TESTING | Heating test | Sample to be tested under normal installation Under 1.06 times Rating Voltage After 30 minutes. | <input checked="" type="checkbox"/> |
| | Salt Spray Test | 5% salt solution concentration, 48h 5%,48H 35, 5% salt water,35+/-2C for 48hrs | <input checked="" type="checkbox"/> |
| | High temperature and Humidity impact | 65+/-2° C for 500 hrs 60°C, 85%RH 60度, 85%RH | <input checked="" type="checkbox"/> |
| | Temperature Shock Test | Manufacturer-defined,-40°C-85°C (typical temperature ange) | <input checked="" type="checkbox"/> |
| | switch test | 30s On, 30s Off, 15000 times on/off every 30S, > 15000 cycles | <input checked="" type="checkbox"/> |
| | Lifetime aging test | 35°C, 6000h | <input checked="" type="checkbox"/> |
| | Constant Temperature Test | Manufacturer-defined,60°C to -40° (typical temperature) | <input checked="" type="checkbox"/> |
| | Winding Test | φ 150mm cylinder, 60N pull, winding 10 times at (-25°C ±2°C) , and 10 times after(-15°C ±2°C, 16h) | <input checked="" type="checkbox"/> |
| | Cold Bend Test | wound on mandrel,low-temperature (-15°C ±2°C, 16h), around the mandrel for two turns | <input checked="" type="checkbox"/> |
| | Cold Impact test | Low-temperature (-15°C ±5°C, 16h), hammer falls from a height of 100mm. | <input checked="" type="checkbox"/> |
| | UV Exposure Test | ASTMG 154,ISO 4892-3, UVA@340nm ASTMG154-06, UVA-340 0.68W/m2 for 300 hrs | <input checked="" type="checkbox"/> |
| | IPX5 IPX6 IPX7 IPX | IEC60529 IP65 -IP67 | <input checked="" type="checkbox"/> |
| | Flame Resistant Test | UL94 | |

包装

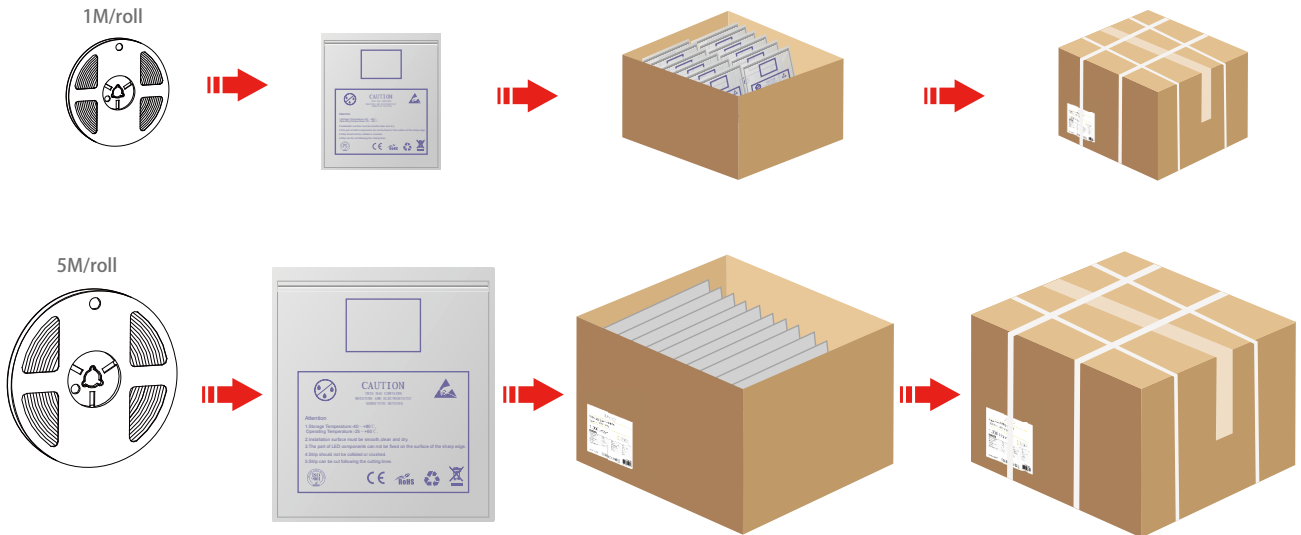

安全信息

LED柔性带的应用注意事项

- 请使用24VDC隔离电源驱动LED灯带，恒压源纹波小于5%。不能通过电阻电容和非隔离电源驱动led条等降压电源为保障灯条的寿命和可靠性，请不要弯曲弧径60mm及以下，不要折叠，以免损坏灯珠或折断。
- 为保证灯具的使用寿命和环境，在使用时不能用力拉电源线，以免损坏LED灯具，禁止碰撞。
- 安装时请注意正负极电源线，不要选电压错误的电源与灯带使用，以免损坏产品。
LED灯带应存储在干燥密封的环境中，建议存储期不宜过长，工作温度-20~+120℃，储存温度:0~+60℃，不防水灯带在室内使用，相对湿度不高于85%。
- 在实际应用中电源应留有20%的余量（建议只使用80%的功率），以保证足够的电压驱动产品。不要使用任何酸性，碱性粘合剂固定产品（包括不限于玻璃，塑料等）